

مشخصات فنی

Type			NSBC 115	NSBC 150	NSBC 185	NSBC 225	NSBC 265	NSBC 330	NSBC 400	NSBC 500	NSBC 630
Poles			3P, 4P								
Rated insulation voltage (Ui)		V	1000								
Rated thermal current (Ith)		A	200	200	275	275	315	380	450	630	800
Rated operation current (Ie)	AC-3, 380V	A	115	150	185	225	265	330	400	500	630
	AC-3, 660V	A	86	108	118	137	170	235	303	353	462
	AC-3, 1000V	A	46	50	71	90	112	155	200	232	311
	AC-4, 660V	A	86	108	118	137	170	235	303	353	462
Max. power of 3 phase motor controlled	AC-3, 380V	kW	55	75	90	110	132	160	200	250	335
	AC-3, 660V	kW	80	100	110	129	160	220	280	335	450
Electrical life	AC-3	10000 t	120		100		80				
Mechanical life		10000 t	1000		600						
Operation frequency	AC-3	t/h	1200		600						
Matching fuse type			RT16-160	RT16-200	RT16-250	RT16-315	RT16-400	RT16-400	RT16-500	RT16-630	RT16-800
Matching thermal relay type			LR9-F53						LR9-F73		
Wiring capacity		mm ²	50	50	95	95	150	185	30×5(2)	40×5(2)	50×5(2)
Coil											
Control power voltage (Us)	AC	V	24, 36, 48, 110, 127, 240, 380, 440								
Allowed control circuit voltage	Close	V	85%~110%Us								
	Open	V	20%~75%Us(AC)								
Coil power	Close	VA	550		800		1200		1200	1250	1650
	Keeping	VA	45		55		13		20	24	22
	Loss power	W	12~16		18~24		12		14	18	20
Auxiliary contact											
Rated thermal current (Ith)		A	10								
Rated operation voltage (Ue)	AC	V	380								
	DC	V	220								
Rated control capacity	AC-15	VA	360								
	DC-13	W	33								

مشخصات عمومی

کنتاکتورهای سری NSBC برای مدارهایی با ولتاژ نامی تا ۱۰۰۰V و جریان نامی تا ۷۸۰A، ۵۰/۶۰HZ اطلاق می گردد.

این کنتاکتور برای قطع مدار از راه دور و استارت مکرر یا کنترل موتور استفاده می شود.



Name	Rated current	Auxiliary contact	Pole number	Coil voltage	Frequency
NSBC	<input type="text"/>	<input type="text"/>	<input type="text"/>	*	.

Rated current (A)	Auxiliary contact		Type
	Normal open (NO)	Normal close (NC)	
115	-	-	NSBC-F11500*.
150	-	-	NSBC-F15000*.
185	-	-	NSBC-F18500*.
225	-	-	NSBC-F22500*.
265	-	-	NSBC-F26500*.
330	-	-	NSBC-F33000*.
400	-	-	NSBC-F40000*.
500	-	-	NSBC-F50000*.
630	-	-	NSBC-F63000*.

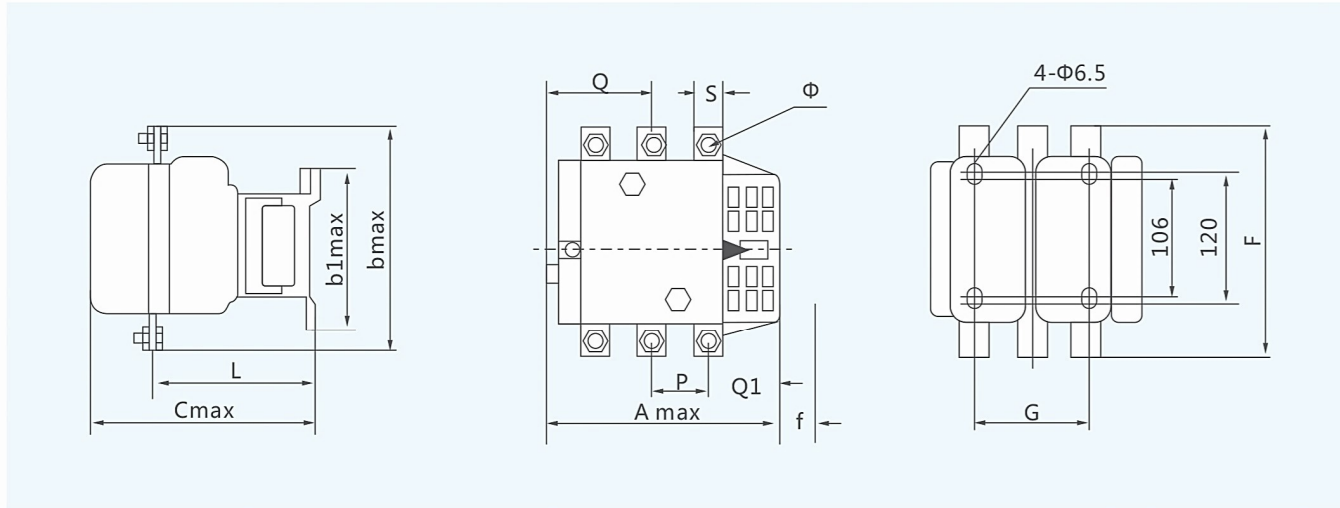

Type	Amax	bmax	b1max	Cmax	G	L	Q	Q1	S	Φ	F	P
NSBC-F115	165	164	137	167	80±0.8	108	29.5	60	15	M6×15	133	37
NSBC-F150	165	172	137	167	80±0.8	108	29.5	57.5	20	M6×20	133	40
NSBC-F185	171	176	137	181	80±0.8	114	30	60	20	M6×20	133	40
NSBC-F225	171	199	137	181	80±0.8	114	22	52	25	M6×30	133	48
NSBC-F265	204	205	145	210	96±1.1	143	39	66.5	25	M10×30	147	48
NSBC-F330	209	209	145	216	96±1.1	148	36	74	25	M10×30	147	48

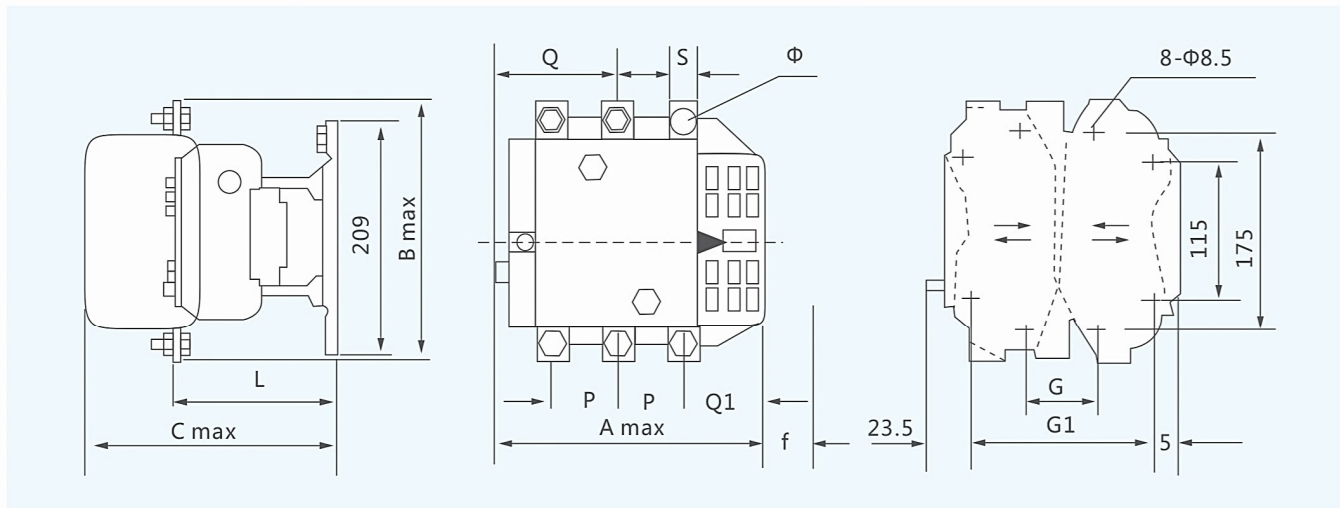

Type	Amax	Bmax	Cmax	f	k	S	L	P	Q	Q1	Gmax	G	Gmax	G1	G1min
NSBC-F400	213	206	213	119	70	25	145	48	43	74	102	80	192	170	156
NSBC-F500	233	238	226	141	70	30	146	55	46	77	120	80	210	170	156

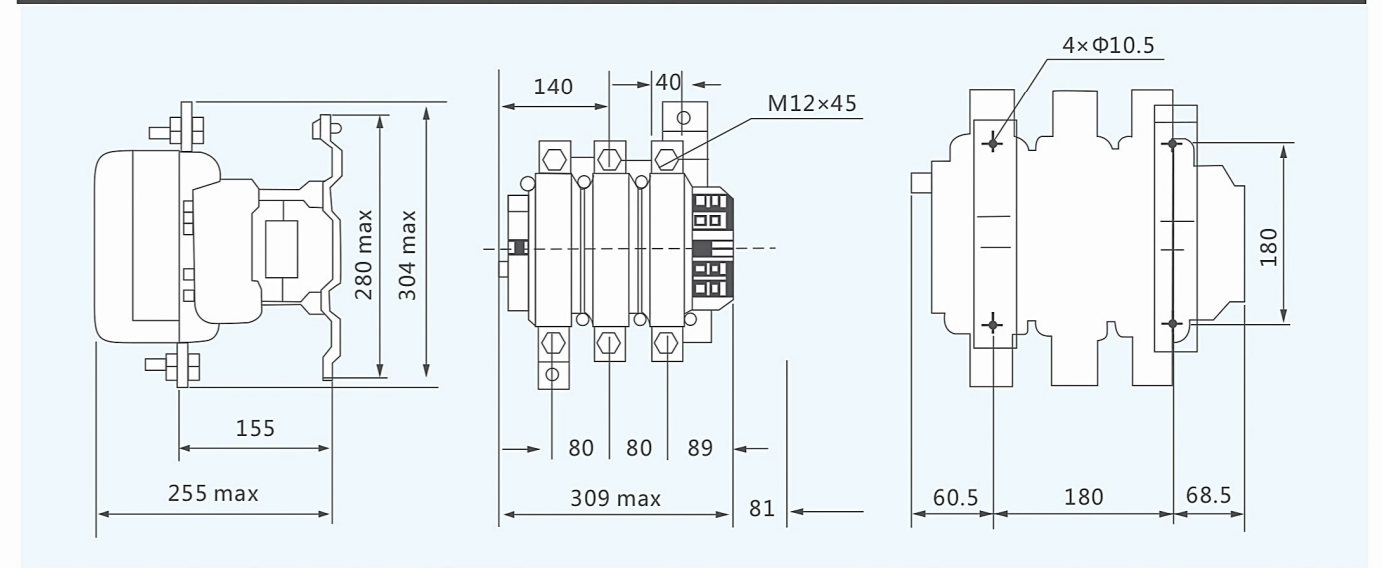

مشخصات

Ambient temperature	-5°C~+40°C
Altitude	≤2000m
Relative humidity	The maximum temperature of 40 degrees, the air relative humidity not exceed 50%, at a lower temperature can allow for a higher relative humidity, if humidity changes as a result of occasional gel generated, should eliminate it.
Pollution level	3
Installation category	III
Installation position	The installation degree of the tilt and vertical plane should not exceed ±22.5°, should be installed in place with no significant impact shaking and vibration
Installation	The installation of fastening screws can be used, the CJX1-9~38 contactor can also be installed on 35mm standard DIN rail.

LX1-F Coil

Type	Product	Contact type	Control power voltage(V)	Coil type(3P)	Coil type(4P)
LX1-F		NSBC -F115,F150	48, 110, 220 380, 440, 660	LX1-F1153	LX1-F1154
		NSBC-F185,F225		LX1-F1853	LX1-F1854
		NSBC-F265,F330		LX1-F2653	LX1-F2654
		NSBC-F400		LX1-F4003	LX1-F4004
		NSBC-F500		LX1-F5003	LX1-F5004
		NSBC-F630		LX1-F6303	LX1-F6304

